

Reversible Latch Lock

- No loose parts
- No need to open lock
- No tools needed to reverse the lock

Just pull & turn

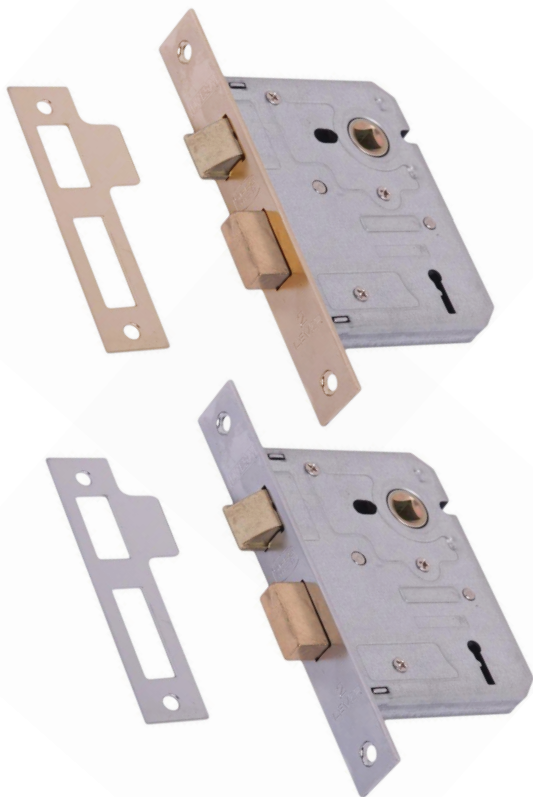
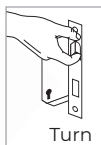

In meeting South African standards SANS 4:2008 a durability test of a 100 000 cycles, was conducted without jamming or breaking.



Gelmar

Fitting Instructions

Step 1

Use the lock body as a template to mark off the position of the cut out in the face of the door.

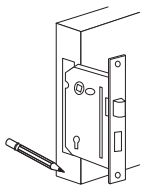

Step 2

Drill a row of 18mm holes 80mm deep in the center of the marked out area.

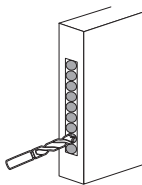

Step 3

Using a chisel, clean out the morticed area between the marked lines.

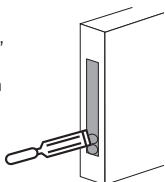

Step 4

Slide the lock into the chiseled hole and draw a line around the faceplate.

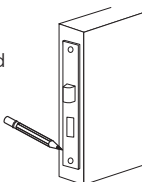

Step 5

Recess the area inside the lines to a depth of 2mm.

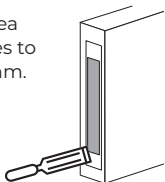

Step 6

Hold lock against the side of the door in line with the recess and mark off the key/cylinder and spindle holes.

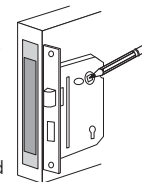

Step 7

Drill a 22mm diameter spindle hole and a 10/17mm key hole through the door.

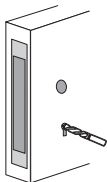

Step 8

If required, pull and turn the latch to match hand of door.

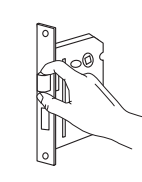

Step 9

Insert lock into the door. Insert spindle and key/cylinder into the lock. Screw the lock into the door.

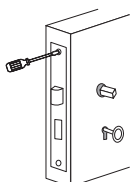

Step 10

Screw furniture onto door and turn key. Close door and mark the position of the latch and deadbolt on the door frame.

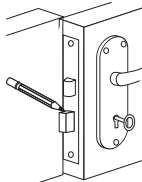

Step 11

Hold striker plate against frame and mark off the latch and deadbolt areas. Drill a row of 12mm holes and clean out this area. Fit striker plate.

